

Series 4, washing machine, front loader, 9 kg, , Silver inox WGA142XVGC



- **AntiStain:** detects and removes the 4 most common stains.
- Pre-Soaking option conveniently helps you remove stubborn and ground-in stains from fabrics by giving you flexible and automatic soaking phase.
- **EcoSilence Drive™:** extremely energy-efficient and quiet in operation with a 10-year warranty.
- **AllergyPlus:** specially developed for the needs of allergy sufferers and sensitive skin.
- **SpeedPerfect:** perfectly clean in up to 65% less time.

Technical Data

Built-in / Free-standing : Free-standing
 Door hinge : Left
 Color / Material body : Silver inox
 Length electrical supply cord : 160 cm
 Height for building under : 845.00 mm
 Height of the product : 845 mm
 Dimensions of the product : 845 x 597 x 588 mm
 Wheels : No
 Net weight : 65.6 kg
 Drum volume : 63 l
 Main colour of product : Silver inox
 Door Frame : Silver-inox, black-grey
 Color Dial : Chrome-black
 Noise level washing : 51 dB(A) re 1 pW
 Connection Rating : 2300 W
 Fuse protection : 10 A
 Voltage : 220-240 V
 Frequency : 50 Hz
 Energy Star Qualified : Yes
 Cord Included : No
 Plug type : GB plug
 Length of drain hose (in) : 59.05
 Length of supply hose (in) : 59.05
 Appliance Dimensions (h x w x d) (inches) : x x
 Dimensions of the packed product : 34.25 x 24.99 x 26.77
 Net weight : 145.000 lbs
 Gross weight : 155.000 lbs
 Length of drain hose : 150.00 cm
 Length of supply hose : 150.00 cm
 Dimensions of the packed product (HxWxD) : 870 x 680 x 635 mm
 Gross weight : 70.2 kg
 Connection Rating : 2300 W
 Fuse protection : 10 A
 Voltage : 220-240 V
 Frequency : 50 Hz
 Water protection system : Multiple water protection
 Number of Options : 8
 Maximum spin speed : 1200 rpm
 Spin speed options : Variable
 Digital countdown indicator : Yes
 Drying progress indicator : LED, LED-display



Series 4, washing machine, front loader, 9 kg, , Silver inox WGA142XVGC

- WGA142XVGC
- Ferrite-BLDC
- EcoSilence drive with 10 year warranty

Main features

- Capacity: 9 kg
- Energy Efficiency Class: 3 Energy Stars
- spin-drying efficiency class: B
- Max. spin speed: 1200 rpm
- Cottons 60 Eco and Cottons 40 Eco are the standard washing programmes to which the information in the label relates. These programmes are suitable to clean normally soiled cotton laundry and are the most efficient programmes in terms of combined energy and water consumption.
- Noise level washing dB (A) re 1 pW: 51
- Noise level spinning dB (A) re 1 pW: 74
- 3 Energy Stars according to the UAE energy efficiency label with energy consumption of 257 kWh per year and water consumption of 14170 l per year

Programmes

Options

- PreSoaking: Works against stubborn stains.
- AntiStain: Automatic removal of the most common stains.
- varioPerfect: time or energy optimized programs with perfect wash performance
- Touch control buttons: Start / Reload / Pause, Reduced Ironing, SpeedPerfect, Spin speed reduction/Yes

Convenience and Safety

- Reload function: Be flexible in adding laundry items even after start of the wash cycle.
- WaveDrum
- Multiple water protection
- Large display for temperature, spin speed, remaining time, 24 h end time delay and load recommendation
- Fully electronic control dial for all wash- and special programs
- AntiVibration Design: more stability and quietness
- 3D AquaSpa wash system with cascade for faster water penetration
- infinitely variable
- loading introduction
- Foam detection system
- Unbalanced load detection
- Self cleaning detergent drawer
- AquaSensor for optimum rinse results: Yes
- Childproof door lock
- Buzzer
- Metal door closing hook
- Magnet Lock

Technical information

- Dimensions (H x W x D): 84.5 x 59.7 x 58.8 cm
- Can be built-under

**Series 4, washing machine, front loader, 9
kg, , Silver inox
WGA142XVGC**

measurements in mm

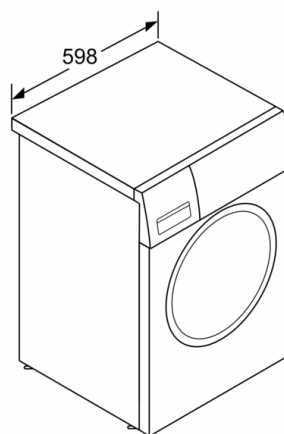
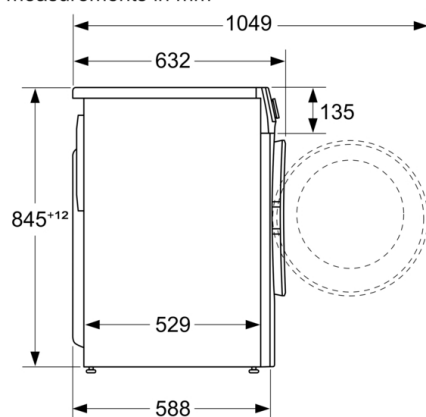

measurements in mm